

4/4/2023

<p><b>General Information</b></p> <p>Tax Map 68-27-0204.001</p> <p>Parcel Address 404 W MARKET STREET POTTSVILLE, PA 17901</p> <p>School District Pottsville Area Municipality Pottsville</p>	<p><b>Legal Information</b></p> <p>Front Of Lot: Depth: Unit of Front: Acres: 0.14</p> <p><a href="#">Land Use Type:</a> 321 Roll Section: 1 <a href="#">Assessment Property Class:</a> CC</p> <p>(Assessment Property Class is NOT a Zoning Classification. Contact the appropriate Municipal Zoning Officer for Zoning Info.)</p>
---	---

<b>Current Ownership Information</b>			
Owner Name	Owner Address	Deed Bk/Pg	Sale Date
ROGUE KATTELIN	PO BOX 13006 HARRISBURG, PA 17110	2703/1958	9/8/2020

<b>Bill To Information</b>	
Owner Name	Owner Address
ROGUE KATTELIN	PO BOX 13006 HARRISBURG, PA 17110

<p><b>Value Data</b></p> <p><b>BASE YEAR: 1996</b></p> <table border="0"> <tr> <td><b>Base Year Value</b></td> <td><b>Assessed Value</b></td> </tr> <tr> <td>Land: 14750</td> <td>Land: 7375</td> </tr> <tr> <td>PA Ag Land:</td> <td>PA Ag Land:</td> </tr> <tr> <td>Misc Structures:</td> <td>Improvements: 33825</td> </tr> <tr> <td>Buildings: 67650</td> <td>Total: 41200</td> </tr> <tr> <td>Total: 82400</td> <td></td> </tr> </table> <p><b>Status</b></p> <p><a href="#">Clean &amp; Green:</a> N <a href="#">Homestead:</a> N</p>	<b>Base Year Value</b>	<b>Assessed Value</b>	Land: 14750	Land: 7375	PA Ag Land:	PA Ag Land:	Misc Structures:	Improvements: 33825	Buildings: 67650	Total: 41200	Total: 82400		<p><b>Site Information</b></p> <p>Site: L</p> <p><a href="#">Terrain:</a> <a href="#">Water Type:</a> P <a href="#">Sewer Type:</a> S Natural Gas: N <a href="#">Road Type:</a> P <a href="#">Location Type:</a> CBD <a href="#">Road Access:</a> C Sidewalk: N <a href="#">Fronting:</a> CBD Rail Access: N</p>
<b>Base Year Value</b>	<b>Assessed Value</b>												
Land: 14750	Land: 7375												
PA Ag Land:	PA Ag Land:												
Misc Structures:	Improvements: 33825												
Buildings: 67650	Total: 41200												
Total: 82400													

<b>Sales History</b>							<a href="#">Hide Sales History</a>
Deed Book	Deed Page	Sale Date	Vacant /Improved	Sale Price	Quals	Grantor	Grantee
1279	0797	9/19/1979	v	\$	n		THOMAS, JOSEPH P
1512	0191	7/14/1993	v	\$75000	u		MANAROULAS JIMMY
1512	0191	7/14/1993	v	\$75000	u		HAZAKIS GEORGE
2703	1958	9/8/2020	i	\$6500	u	MANAROULAS JIMMY	ROGUE KATTELIN
2703	1958	9/8/2020	i	\$6500	u	HAZAKIS GEORGE	ROGUE KATTELIN

<b>Building Information</b>		<a href="#">Hide Buildings</a>
<b>Building (comm) 1 of 5</b>		
Stories:	Finished Basement:	Total Living Area:
Total Rooms:	Attic with Stairs	Total Perimeter:
Bed Rooms:	Dug Basement %:	<a href="#">Exterior Wall 1:</a>
Family Rooms:	Year Built: 1900	<a href="#">Exterior Wall 2:</a>
Full Baths:	Effective Age: 1900	# of Car Garage:
Half Baths:	Exterior Condition:	Sq. Ft of Garage:
Heating Type:	Interior Condition:	Sq. Ft. Encl. Porch:
Fireplace Count:	House Grade:	Building Value: 16632
Central Air:	Building Use Code: 01	
Sketch Floor: 01	Unfinished Basement: None	Heating Type: None
Floor Type/Finish: Wood	Interior Wall: Plaster	Class of Construction: D

Commercial Grade: D - Low Quality

Exterior Wall: Brick

**Building (comm) 2 of 5**

Stories:	Finished Basement:	Total Living Area:
Total Rooms:	Attic with Stairs	Total Perimeter:
Bed Rooms:	Dug Basement %:	<a href="#">Exterior Wall 1:</a>
Family Rooms:	Year Built: 1900	<a href="#">Exterior Wall 2:</a>
Full Baths:	Effective Age: 1900	# of Car Garage:
Half Baths:	Exterior Condition:	Sq. Ft of Garage:
Heating Type:	Interior Condition:	Sq. Ft. Encl. Porch:
Fireplace Count:	House Grade:	Building Value: 20790
Central Air:	Building Use Code: 01	
Sketch Floor: 01	Unfinished Basement: 76 - 100%	Heating Type:
Floor Type/Finish: Wood	Interior Wall: Plaster	Class of Construction: D
Commercial Grade: D - Low Quality	Exterior Wall: Brick	

**Building (comm) 3 of 5**

Stories:	Finished Basement:	Total Living Area:
Total Rooms:	Attic with Stairs	Total Perimeter:
Bed Rooms:	Dug Basement %:	<a href="#">Exterior Wall 1:</a>
Family Rooms:	Year Built:	<a href="#">Exterior Wall 2:</a>
Full Baths:	Effective Age:	# of Car Garage:
Half Baths:	Exterior Condition:	Sq. Ft of Garage:
Heating Type:	Interior Condition:	Sq. Ft. Encl. Porch:
Fireplace Count:	House Grade:	Building Value:
Central Air:	Building Use Code: 60	
Sketch Floor:	Unfinished Basement:	Heating Type:
Floor Type/Finish:	Interior Wall:	Class of Construction:
Commercial Grade:	Exterior Wall:	

**Building (comm) 4 of 5**

Stories:	Finished Basement:	Total Living Area:
Total Rooms:	Attic with Stairs	Total Perimeter:
Bed Rooms:	Dug Basement %:	<a href="#">Exterior Wall 1:</a>
Family Rooms:	Year Built: 1955	<a href="#">Exterior Wall 2:</a>
Full Baths:	Effective Age: 1955	# of Car Garage:
Half Baths:	Exterior Condition:	Sq. Ft of Garage:
Heating Type:	Interior Condition:	Sq. Ft. Encl. Porch:
Fireplace Count:	House Grade:	Building Value: 31637
Central Air:	Building Use Code: 07	
Sketch Floor: 01	Unfinished Basement: 76 - 100%	Heating Type:
Floor Type/Finish: Wood	Interior Wall: Plaster	Class of Construction: C
Commercial Grade: C - Average Quality	Exterior Wall: Steel	

**Building (comm) 5 of 5**

Stories:	Finished Basement:	Total Living Area:
Total Rooms:	Attic with Stairs	Total Perimeter:
Bed Rooms:	Dug Basement %:	<a href="#">Exterior Wall 1:</a>
Family Rooms:	Year Built: 1900	<a href="#">Exterior Wall 2:</a>
Full Baths:	Effective Age: 1900	# of Car Garage:
Half Baths:	Exterior Condition:	Sq. Ft of Garage:
Heating Type:	Interior Condition:	Sq. Ft. Encl. Porch:
Fireplace Count:	House Grade:	Building Value: 240
Central Air:	Building Use Code: 51	
Sketch Floor: 01	Unfinished Basement: None	Heating Type: Other
Floor Type/Finish: Other	Interior Wall: Other	Class of Construction: D
Commercial Grade: D - Low Quality	Exterior Wall: Other	

**Miscellaneous Structures**

[Hide Structures](#)

**No Miscellaneous Structures Found**

**Sketches** [Hide Sketches](#)

**Image Id:70542-1**

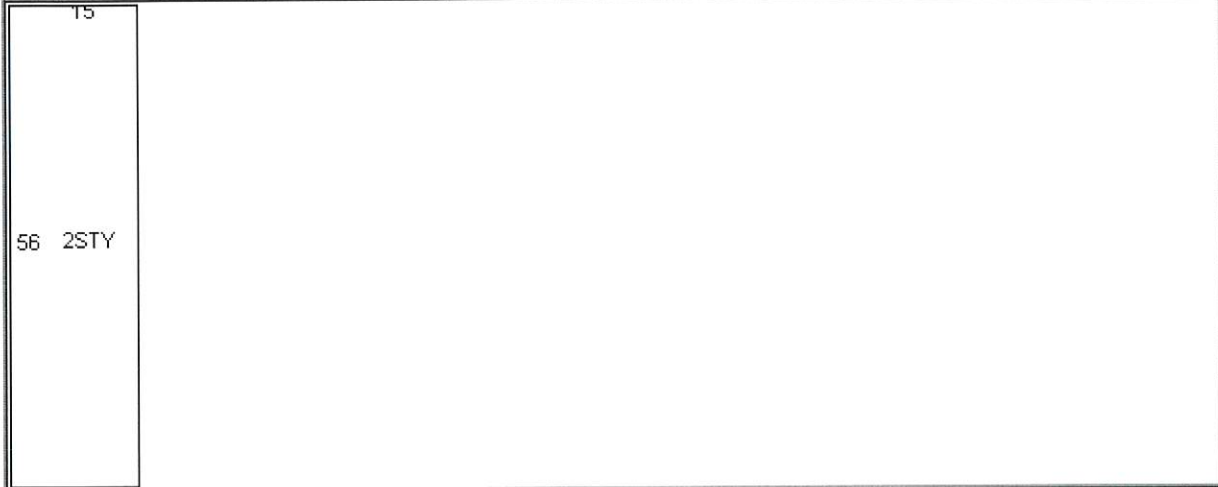

**Image Id:70542-0**



**Image Id:70542-2**

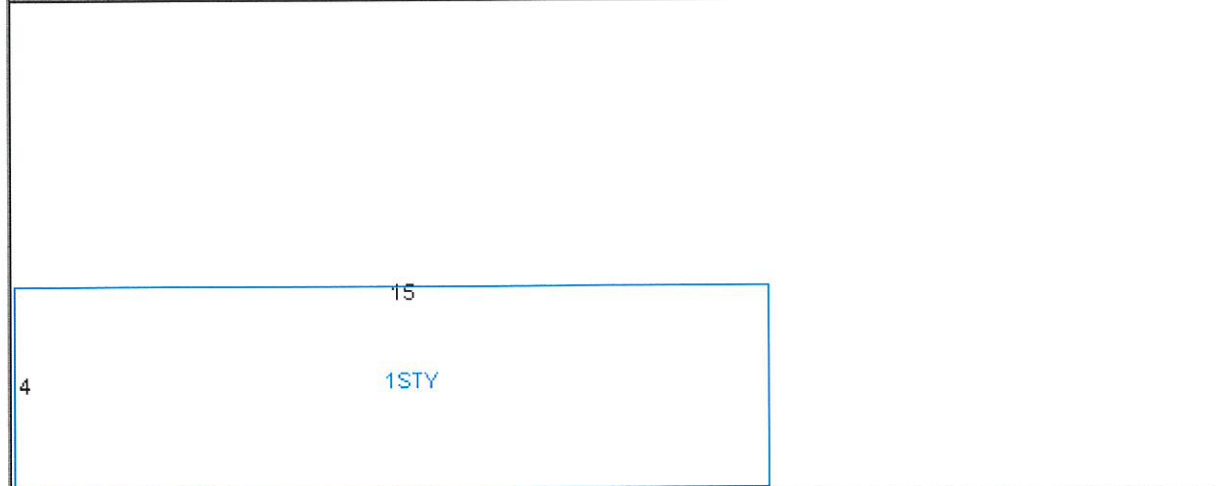

**Image Id:70543-0**



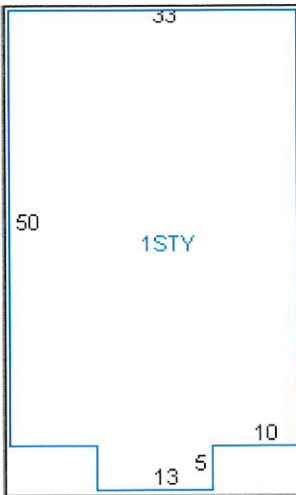

Image Id:70542-3



**Pictures**

[Hide Pictures](#)

Pictures: 2





Schuylkill County Assessment Bureau CAMA Card

4/4/2023